

DryLock® 2 Assembly for A7 Pumps Version 2.2

DryLock® II Product Update

The latest update builds upon the reliable features and benefits of the base DryLock® 2 system in use since 2011 but now with reduced parts. We have designed a new unitized rotary seal sleeve (24J) that replaces four prior components: rotary seal ring (24G), seal sleeve (24), locknut (24F), and rotary seal o-ring (24H). The new unitized rotary seal sleeve reduces cost, complexity and assembly time over the previous iteration and is fully interchangeable with all versions of the DryLock® 2 Static Seal.

4 Piece Rotary Seal Sleeve (Version 2.1)

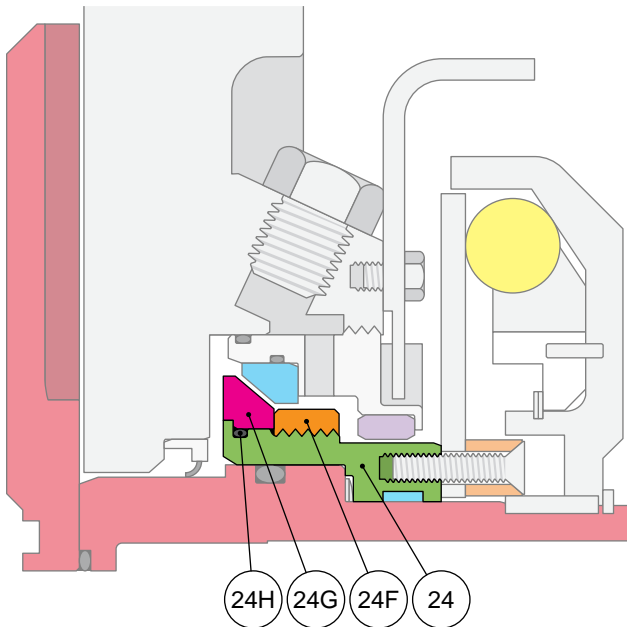

1 Piece Rotary Seal Sleeve (Version 2.2)

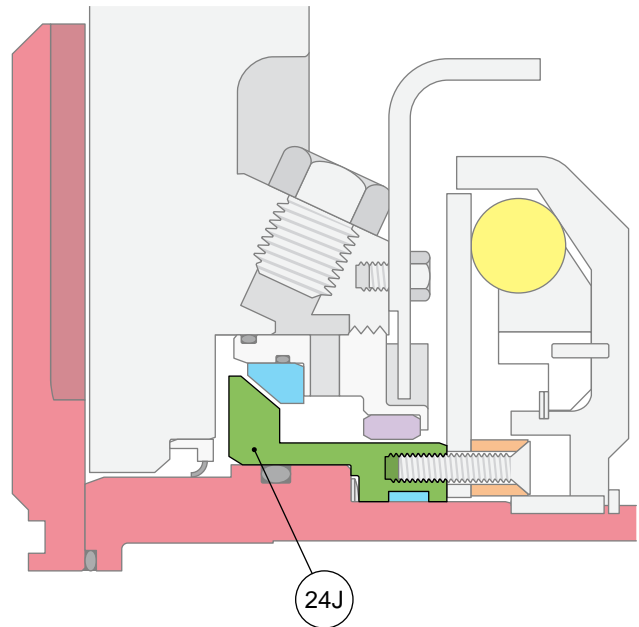

Setting the Seal Clearance

Seal clearance MUST be set after the assembly has been installed in the pump

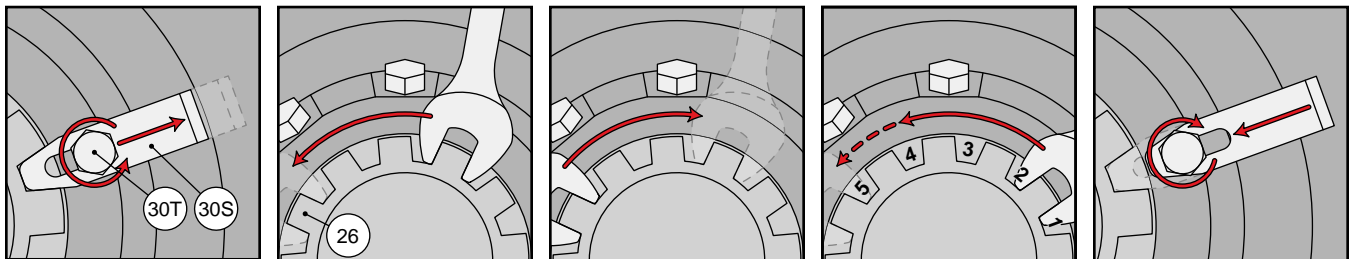

Loosen
posi-lock bolt (30T)
Disengage
posi-lock pin (30S)

Loosen seal cartridge (26)
minimum 1 visible thread

Set impeller clearance
Tighten seal cartridge (26)
until it bottoms out

Loosen seal cartridge (26)
to set seal clearance
4 full tabs (frames 1-2)
5 full tabs (frames 3-4)

Reengage
posi-lock pin (30S)
Tighten
posi-lock bolt (30T)

Refer to the A7 operating manual for complete instructions

DryLock® 2 Assembly for A7 Pumps Version 2.2, All Frames

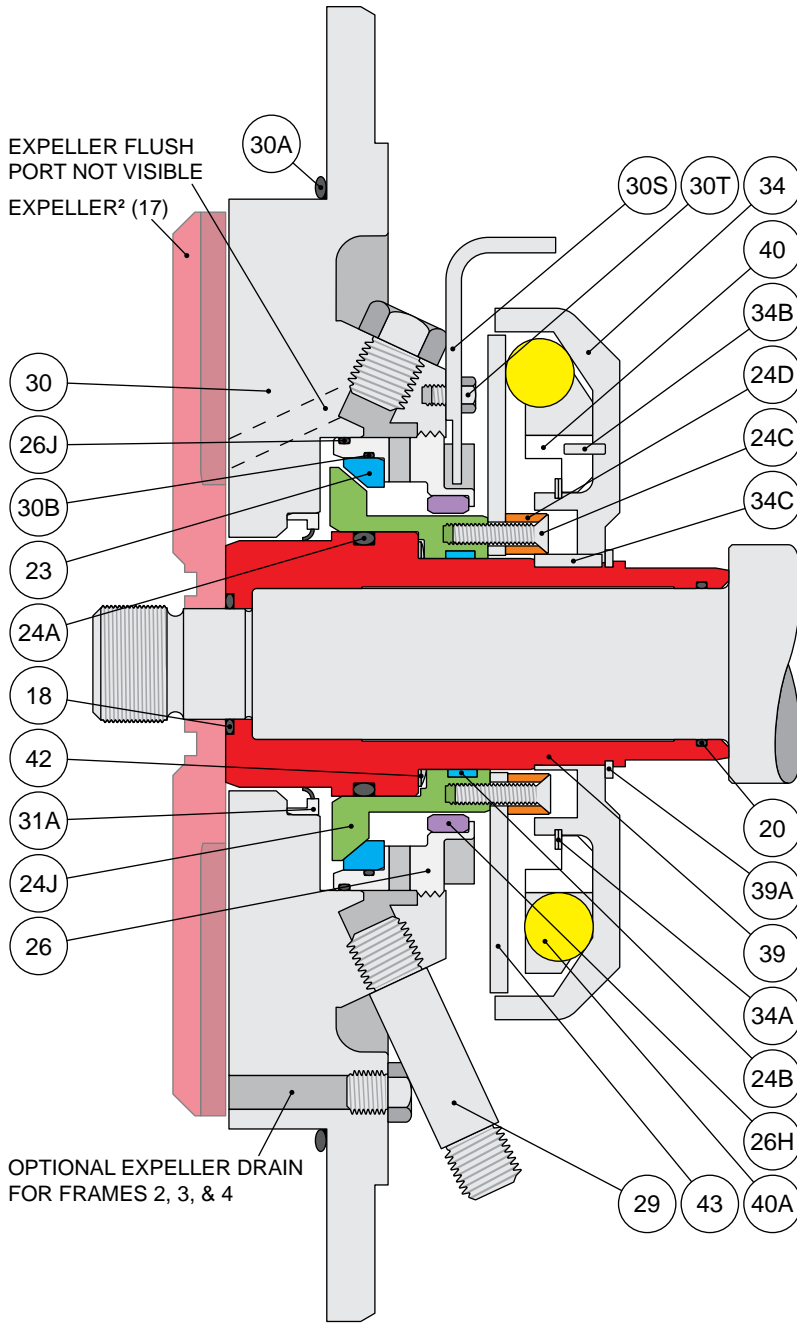

OPTIONAL EXPELLER DRAIN FOR FRAMES 2, 3, & 4

OPTIONAL EXPELLER DRAIN FOR FRAME 1

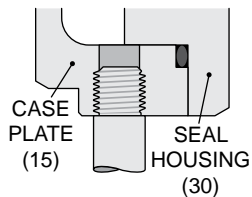

ITEM NO.	QTY.	DESCRIPTION
18 ¹	1	O-RING, SHAFT SLEEVE
20 ¹	1	O-RING, SHAFT
23 ¹	1	STATIONARY SEAL RING
24A ¹	1	O-RING, SEAL SLEEVE
24B ¹	1	SLIDE RING
24C	4	DRIVE SCREW
24D	4	DRIVE SCREW SLEEVE
24J	1	ROTARY SEAL SLEEVE
26	1	SEAL CARTRIDGE
26H	1	DISASTER BUSHING
26J ¹	1	O-RING, CARTRIDGE
29	1	DRAIN SPOUT
30	1	SEAL HOUSING
30A ¹	1	O-RING, SEAL HOUSING
30B ¹	1	O-RING, STATIONARY SEAL RING
30S	1	POSI-LOCK PIN
30T	1	POSI-LOCK BOLT
31A ¹	1	VARILIP
34	1	BALL HOUSING
34A	1	RETAINING RING
34B	1	SPRING PIN
34C	1	KEY
39	1	SHAFT SLEEVE
39A	1	RETAINING RING
40	1	BALL RETAINER
40A	3-18	BALLS
42	1	WAVE SPRING
43	1	ACTUATOR PLATE

DRAWING IS NOT TO SCALE AND REPRESENTS ONLY THE GENERAL ARRANGEMENT OF PARTS

¹ RECOMMENDED SPARE PARTS

² EXPELLER NEEDS TO BE ORDERED IN ADDITION TO THE DRYLOCK® II ASSEMBLY

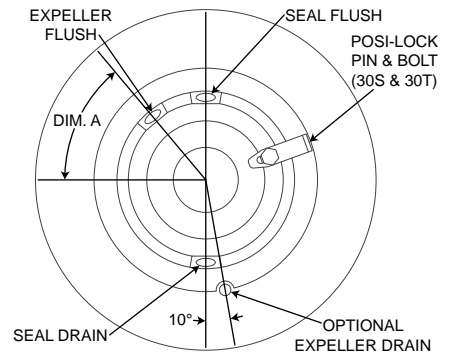

VERSION HISTORY

VERSION	DESCRIPTION	DATE
2.0	Initial release	APR. 2011
2.1	Posi-Lock pin	AUG. 2012
2.2	Unitized rotary seal	JUL. 2013

	DIM. A	STANDARD PORTS	OPTIONAL EXPELLER DRAIN
FRAME 1	30°	3/8" NPT	1/4" NPT
FRAME 2 - 8"	50°	3/8" NPT	1/8" NPT
FRAME 2 - 10"	50°	3/8" NPT	1/4" NPT
FRAME 3	15°	1/2" NPT	1/4" NPT
FRAME 4	20°	1/2" NPT	1/4" NPT